

Consejos de Conservación

1. No debe utilizarse en la limpieza, abrasivos como lana de acero, alcohol, limón, o productos corrosivos que puedan rayar o quitar la película en los muebles.
2. Cuando la limpieza de muebles en general, napa y formica, deben utilizarse un paño ligeramente humedecido y jabón suave.
3. Para mover el mueble, es importante que este se eleve desde el suelo, debido a que el arrastre puede causar daño estructural.
4. No deje el mueble en exposición a la intemperie.

Conservation Tips

1. Do not use abrasive products to clean such as steel wool, alcohol, vinegar, lemon, scouring powder, or corrosive products which can scratch or peel off the protective film of the furniture.
2. The best way to clean your furniture is to use a slightly moistened cloth with a mild soap.
3. To move the furniture assembled, it is important that it is lifted off the ground, because the drag it can cause structural damage.
4. Do not leave your furniture in weather exposure.

Dicas de conservação

1. Não utilizar na limpeza produtos abrasivos tais como: palha de aço, álcool, vinagre, limão, saponáceo ou produtos corrosivos que possam riscar ou descolar a película protetora dos móveis.
2. Na limpeza de móveis em geral, napa e fórmicas, deve ser utilizado um pano levemente umedecido e sabão neutro.
3. Para a movimentação do móvel, é importante que este seja levantado do chão, pois ao arrastá-lo pode causar avarias estruturais.
4. Não deixe o móvel em exposição a intempéries.

Conseils d'entretien

1. Ne pas utiliser de produits abrasifs dans le nettoyage, tels que: laine d'acier, alcool, vinaigre, citron, poudre à récurer ou autres produits corrosifs pouvant rayar ou faire décoller la pellicule protectrice des meubles.
2. Pour le nettoyage du meuble, il est recommandé d'utiliser un chiffon humide et du savon neutre.
3. Pour déplacer le meuble, il est important de le soulever du sol car le tirer pourrait causer des dommages dans sa structure.
4. Ne pas exposer le meuble aux intempéries.

LISTA DE PEÇAS / PARTS LIST / LISTA DE PEÇAS / LISTE DES PIÈCES

#	Cantidad Quantity Quantidade Quantité	Piezas	Pieces	Peças	Pièces	Dimensiones Dimension Dimensões Dimension
1	1	Lateral Esquerda	Left Side Panel	Lateral Esquerda	Côté Gauche	903 x 444 x 12
2	1	Lateral Derecha	Right Side Panel	Lateral Direita	Côté Droit	903 x 444 x 12
3	1	División	Division Panel	Divisão	Séparateur	818 x 416 x 12
4	1	Base	Base Panel	Base	Fond	779 x 444 x 15
5	1	Tapa	Top	Tampo	Pièce du Dessus	805 x 445 x 15
6	1	Tapa Cajones	Drawers Top Panel	Tampo Gavetas	Pièce du Dessus Tiroir	449 x 380 x 12
7	1	Zócalo	Baseboard	Rodapé	Socle	779 x 70 x 12
8	2	Frente Cajón Menor	Small Front Drawer	Frente Gav. Menor	Façade Petit Tiroir	444 x 189 x 12
9	2	Travessa Cajón Menor	Small Drawer Back	Costa Gaveta Menor	Pièce Arrière Petit Tiroir	399 x 80 x 12
10	1	Frente Cajón Mayor	Bigger Front Drawer	Frente Gav. Maior	Façade Grand Tiroir	444 x 285 x 12
11	2	Lateral Cajón Mayor	Large Drawer Side	Lateral Gavetão	Côtés Droit et Gauche Grand Tiroir	350 x 150 x 12
12	1	Repisa	Shelf	Prateleira	Étagère	318 x 400 x 12
13	1	Trasero Cajón Mayor	Large Drawer Back	Costa Gavetão	Pièce Arrière Grand Tiroir	399 x 150 x 12
14	4	Lateral Cajón Menor	Small Drawer Side	Lateral Gav. Menor	Côtés Droit et Gauche Petit Tiroir	350 x 80 x 12
15	1	Puerta Deslizante	Sliding Door	Porta de Correr	Porte Coulissante	813 x 323 x 12
16	1	Tirador	Handle	Puxador	Poignée	591 x 35 x 15
17	3	Corredera Metálica	Metalic Sliding	Corred. Metálica	Glissière Métallique	350mm
18	1	Traseira Mayor	Large Back Panel	Costa Maior	Grande Pièce Arrière	841 x 334 x 3
19	2	Traseira Menor	Small Back Panel	Costa Menor	Petit Pièce Arrière	466 x 341 x 3
20	3	Fondo Cajón	Drawer Bottom	Fundo Gaveta	Fond Tiroir	423 x 355 x 3
21	2	Perfil Sup e Inf	Lower-Upper Profile	Trilho Porta Correr	Glissière	776mm

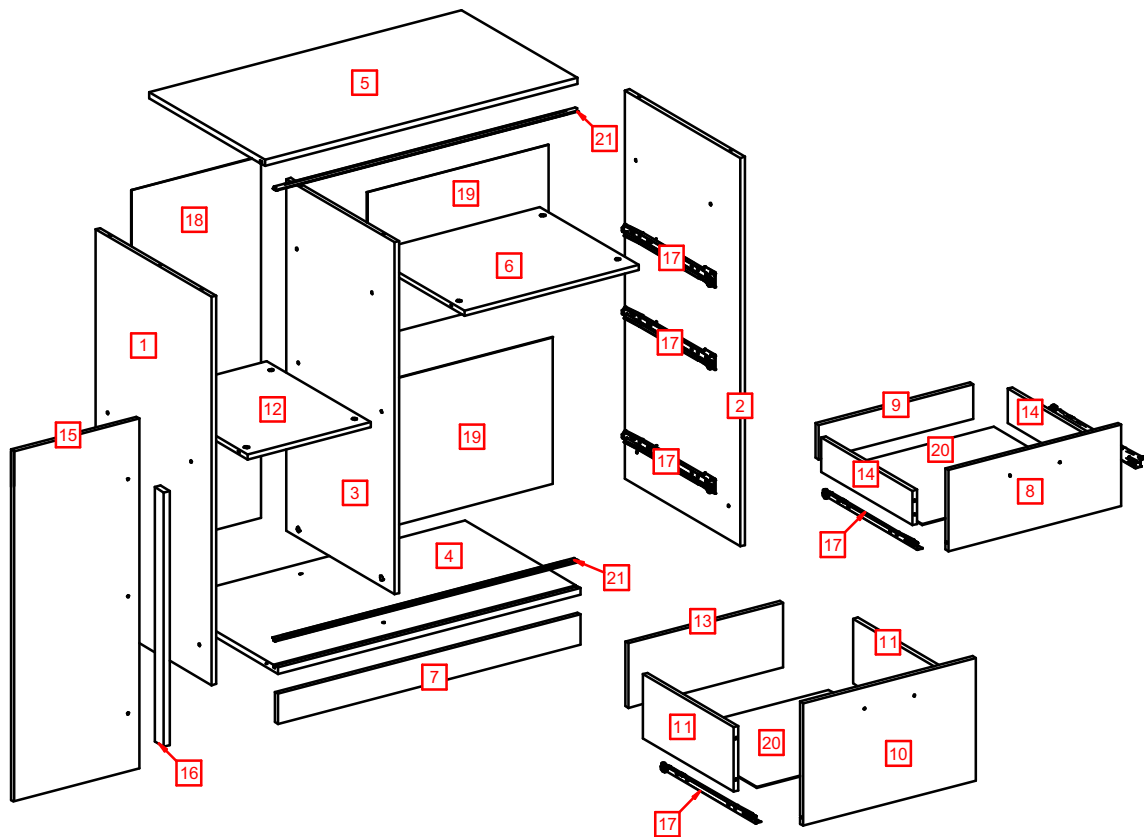

HERRAMIENTAS / HARDWARE
FERRAMENTAS / OUTILS



PERSONAS NECESARIAS PARA EL MONTAJE
PEOPLE REQUIRED FOR ASSEMBLY
PESSOAS NECESSÁRIAS PARA A MONTAGEM
NOMBRE DE PERSONNES NÉCESSAIRES À L'ASSEMBLAGE





A-52x

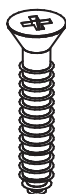

B-6x

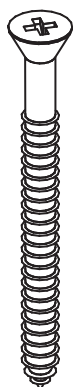

C-14x



D-3x



E-10x



F-60X



G-18X



H-14X



I-4x

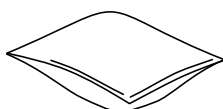

J-1x

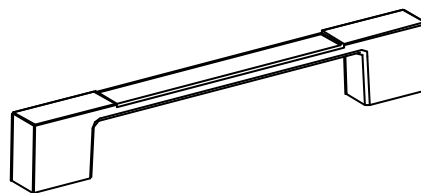

K-3x



L-6x

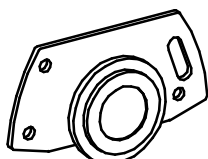

M-2x

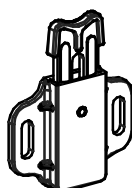

N-2x



O-12x

1

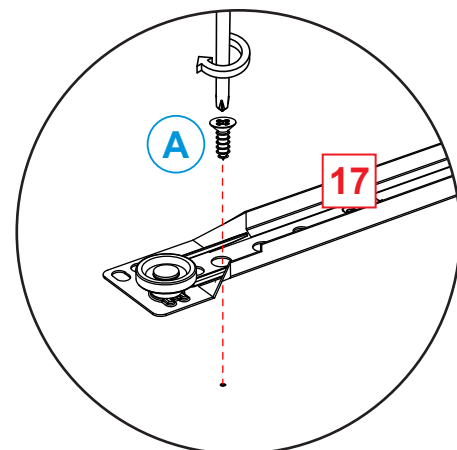
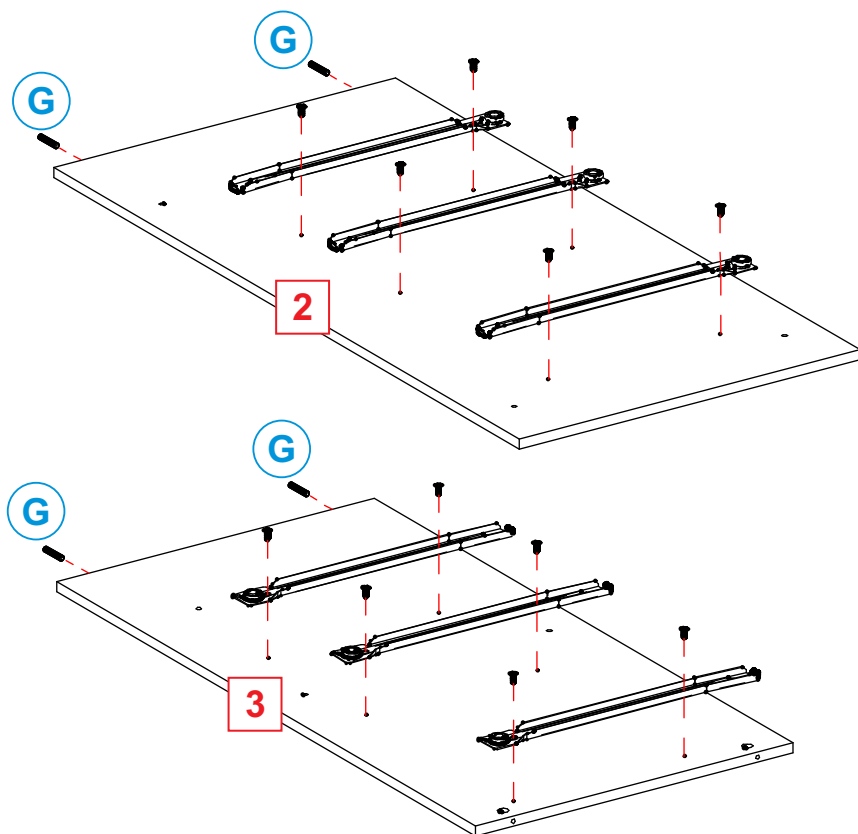

2

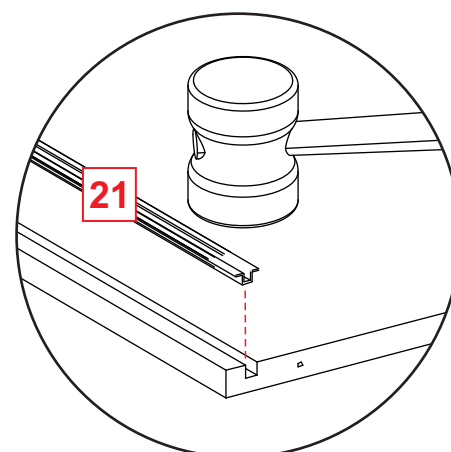
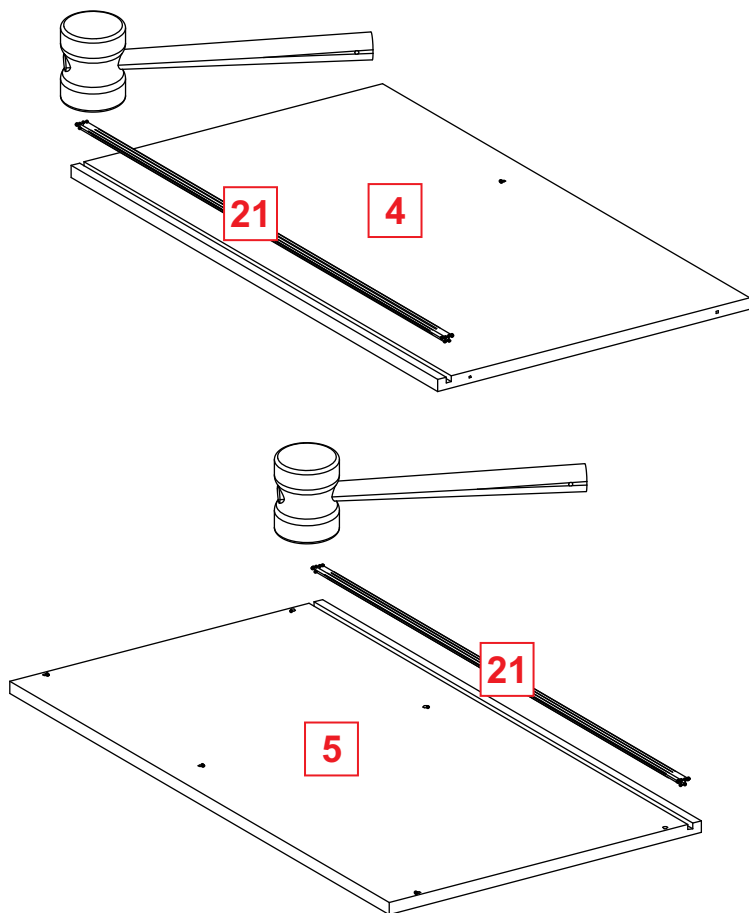

3

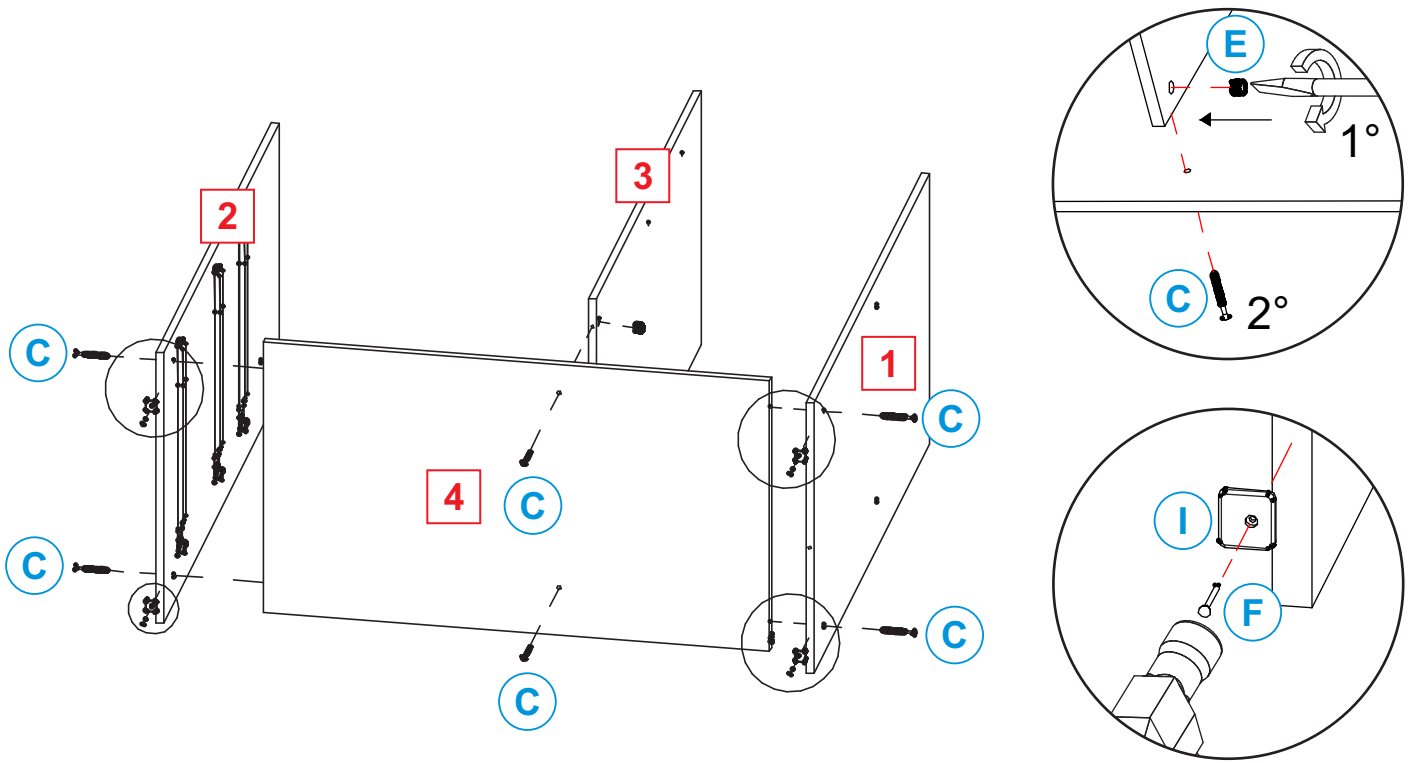

4

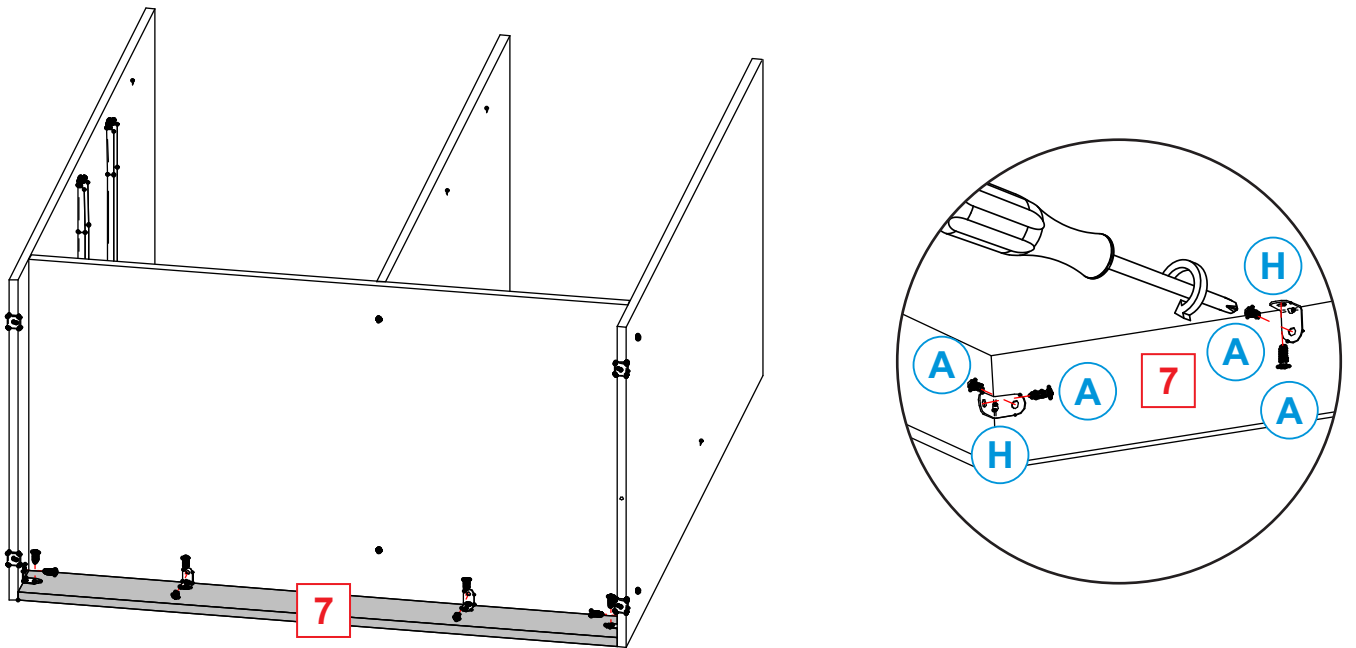

5

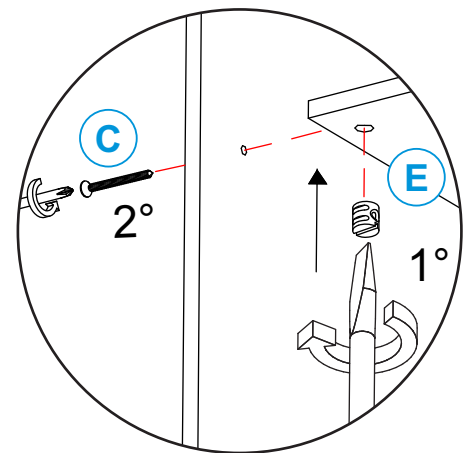
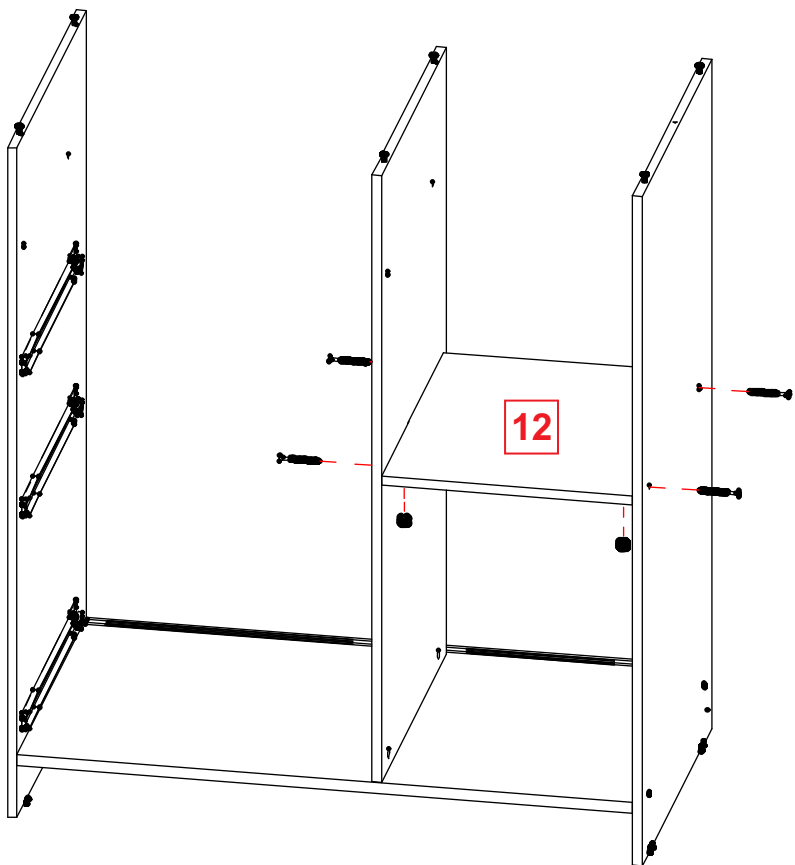

6

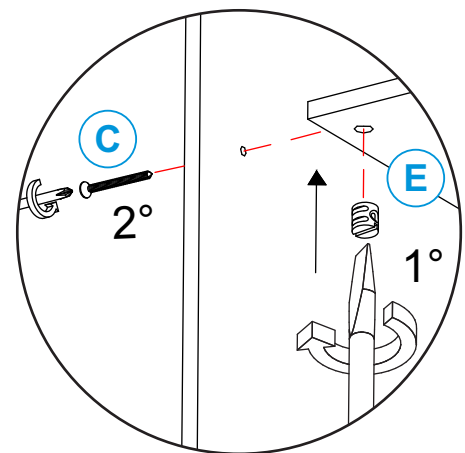
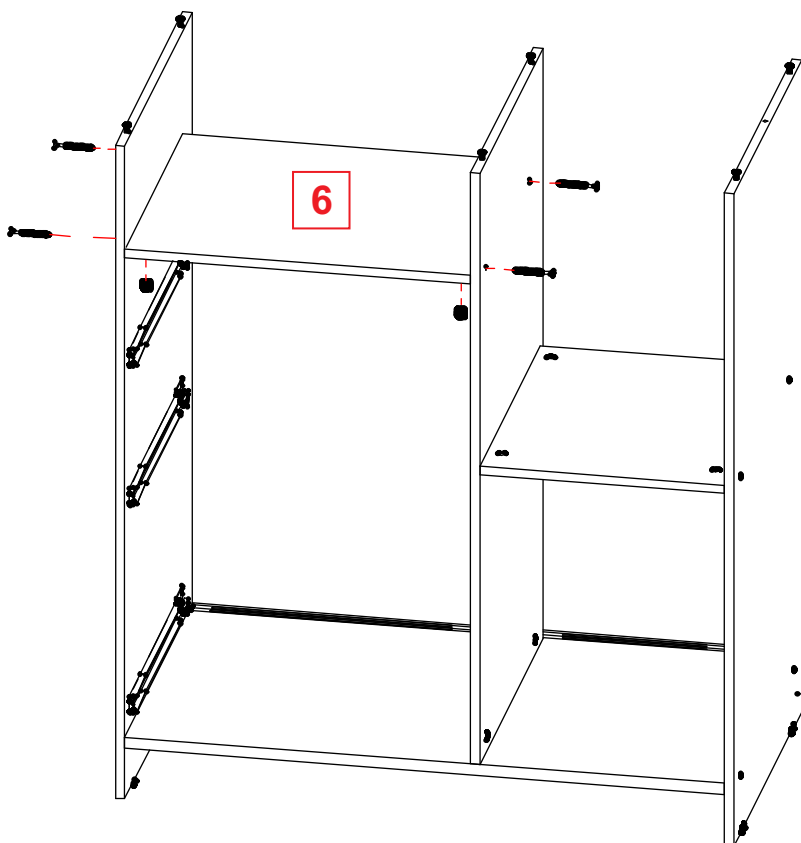

7

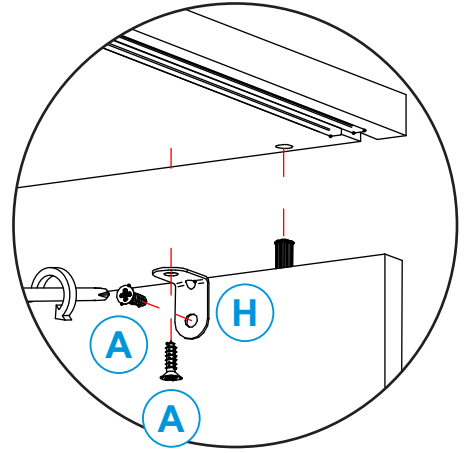
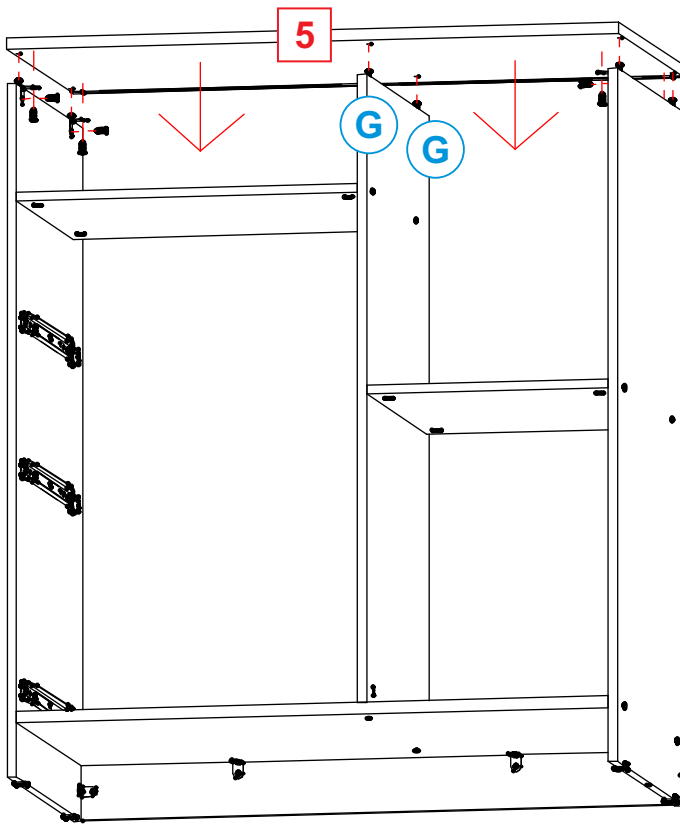

8

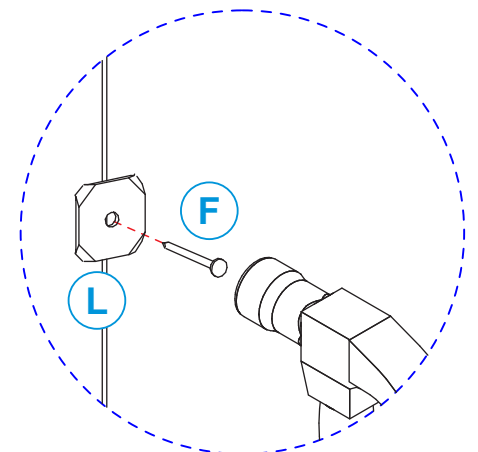
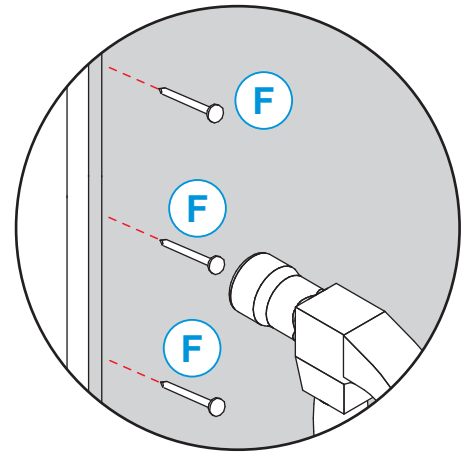
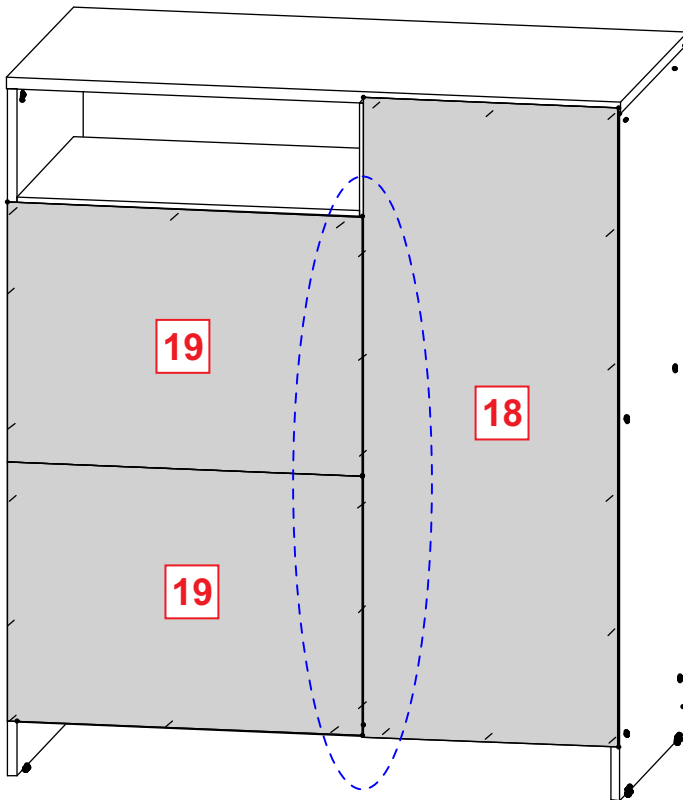

7

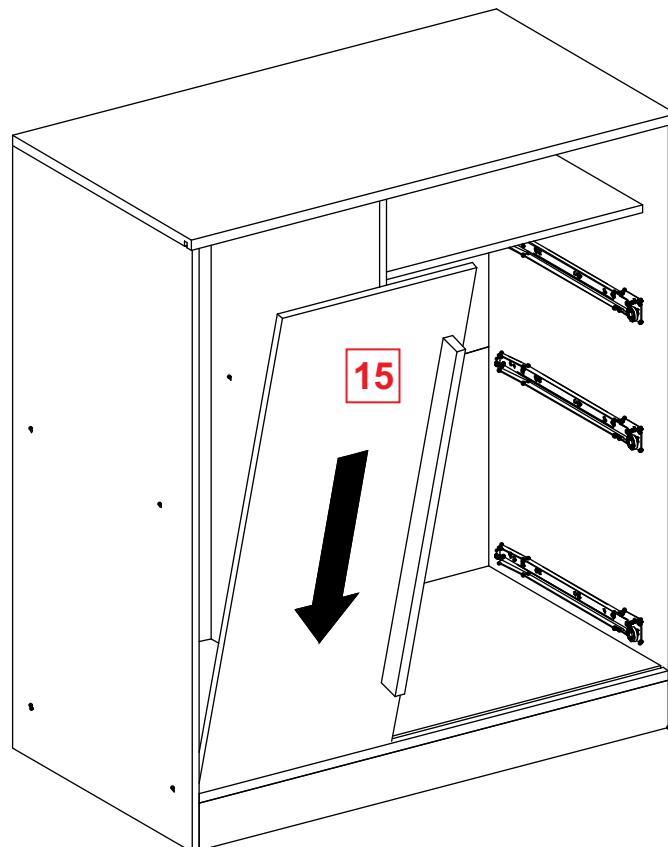
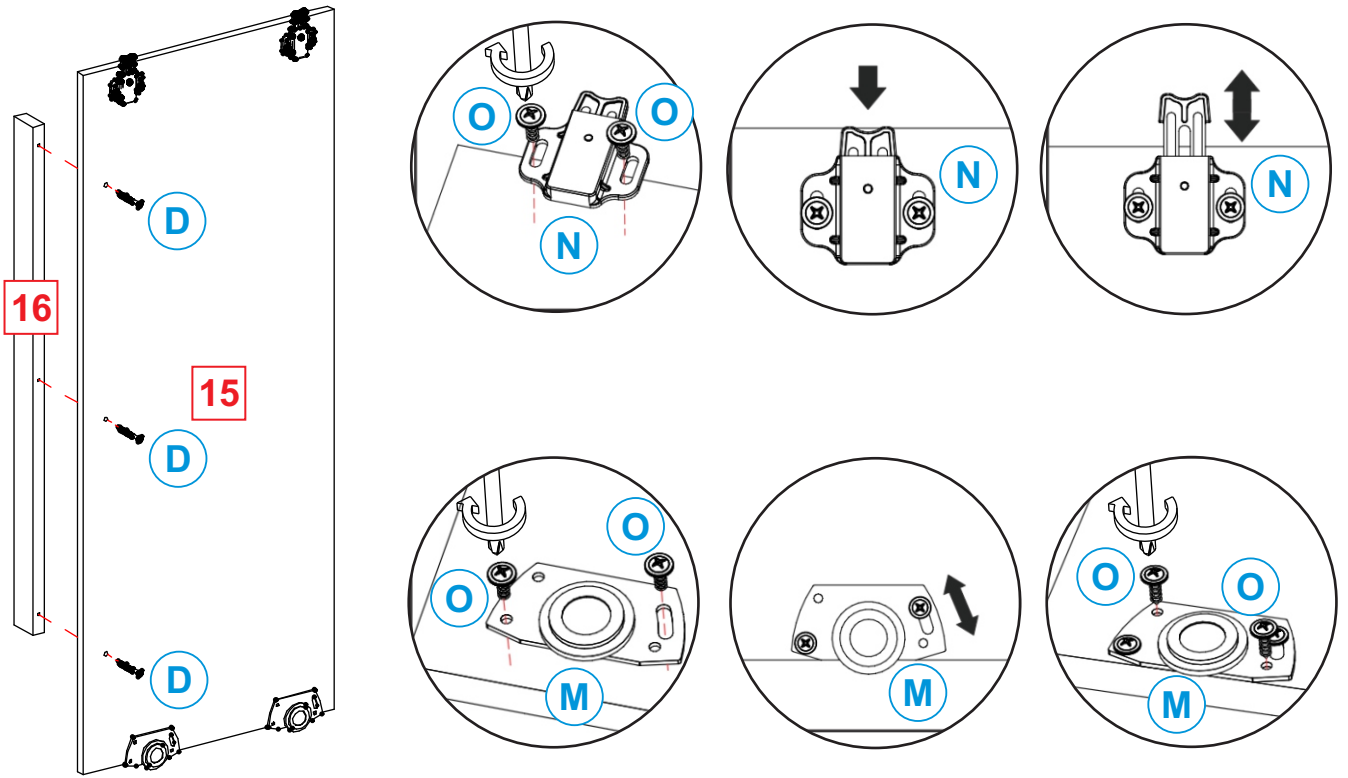

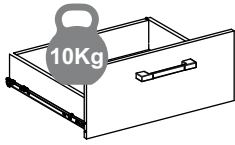

2X

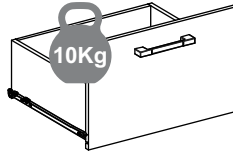

1X

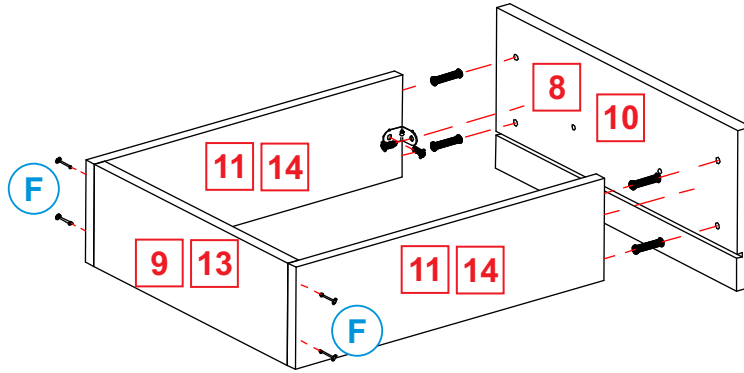
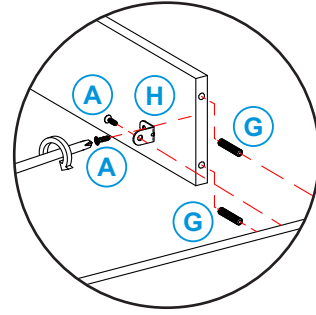

12

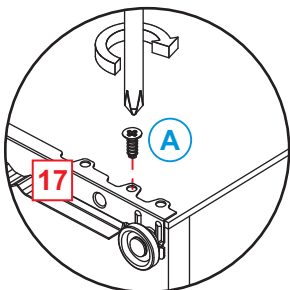
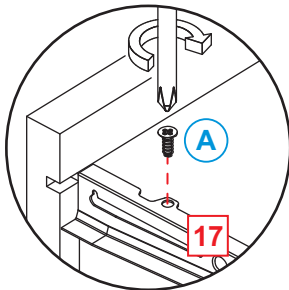
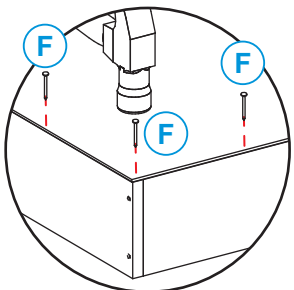
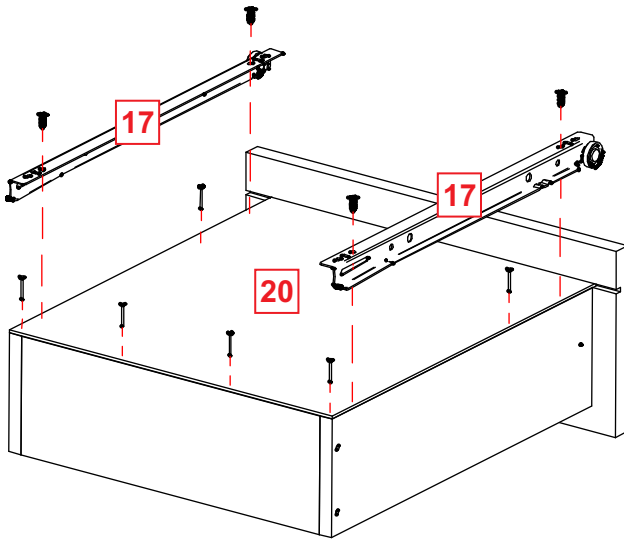

13

